

## Operation

### Operation Model P1100, P1105, P1110, P1115, P1120, P1125

To open the hanging:  
Pull the cord on the tassel downwards.  
When the tassel is released, the hanging stays in the desired position.

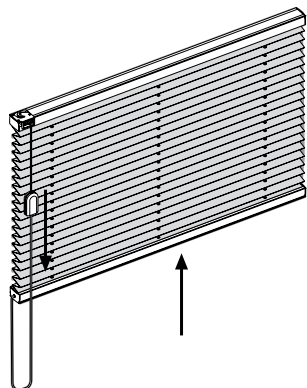

To close the hanging: Pull the tassel to the middle of the hanging, guide it at an angle to the cord lock. The hanging closes.

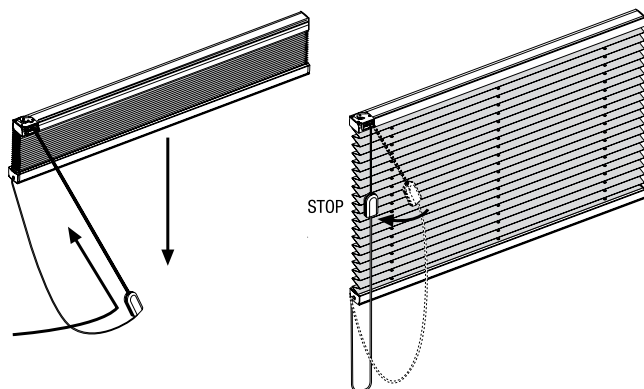

### Operation Model P1200, P1205

Pleated blind with a chain drive, the blind is closed or opened by pulling the front or rear chain respectively.

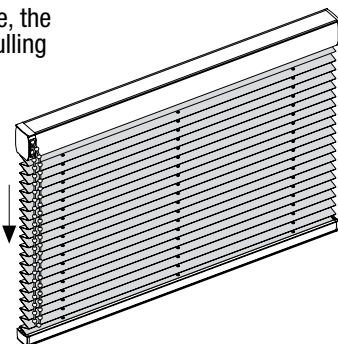

## Operation

### Operation Model P1300, P1305

Pleated blinds with motorised-operation. Please note the installation instructions "Electrical installation".

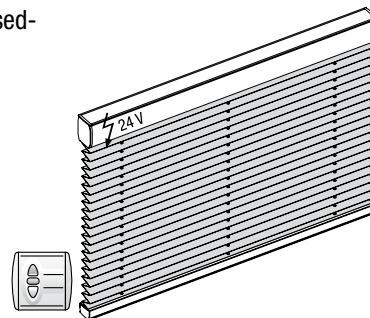

### Operation Model P1434, P1435, P1436, P1437, P1450, P1462, P1463

Tensioned pleated blind is closed and opened by moving the operating handle.

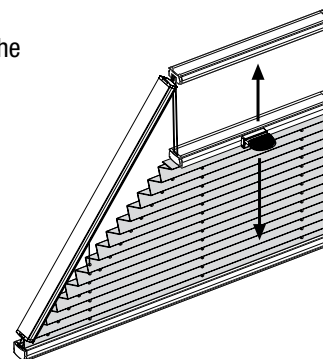

### Operation Model P1000, P1040, P1042, P1080, P1085

These pleated blind models are stationary and cannot be operated.

## Care

Thanks to a special manufacturing process, our fabric qualities are furnished with an antistatic finish and are therefore resistant to dust and dirt. Occasional brushing with a soft brush or a feather duster is usually sufficient.

When cleaning glass and the window frame, make sure that no water or caustic cleaning agents come into contact with the pleated blind fabric.

No guarantee can be offered for damage to fabrics that is attributable to Condensation, cleaning agents or soiling by insects.

## Installation – Operation – Care

### Pleated Blind

**P1100, P1105, P1110, P1115, P1120, P1125, P1200, P1205, P1300, P1305, P1434, P1435, P1436, P1437, P1450, P1462, P1463, P1000, P1040, P1042, P1080, P1085**

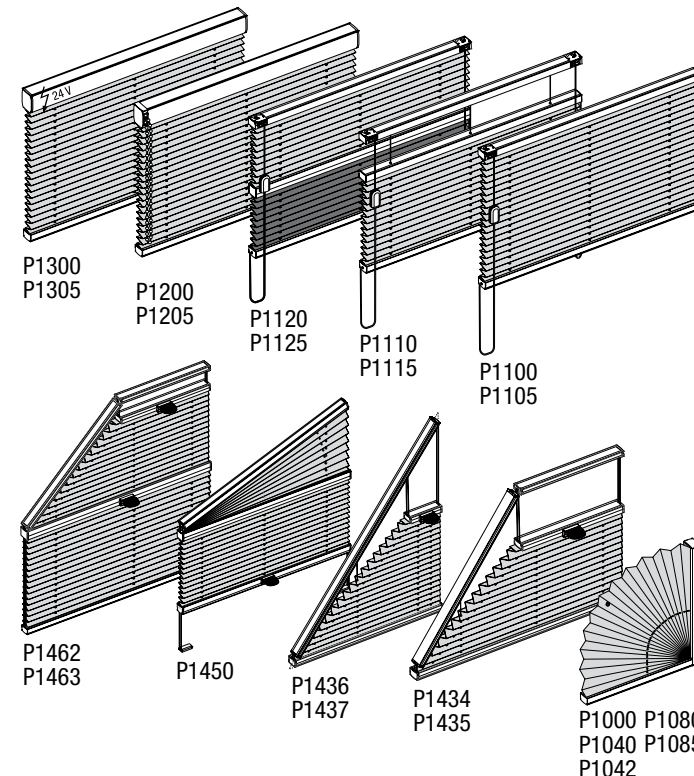

### Dear Customer,

this dimensionally accurate pleated blind was produced especially according to your requirements. High quality materials and a design that is perfect in function and elegance guarantee a long service lifetime and thus ensure great pleasure in the purchased product.

**! Please read the following instructions carefully before installing the blind !**

Mounting by a professional is required. Wrong mounting may result in accidents. Modifications of the product may only take place according to agreement with the manufacturer.

No mounting screws for fixing is enclosed. Please ensure to use screws suitable for the window material and with sufficient strength.

## Clip mounting

Mount the clips 50 mm (standard profile) and 65 mm (motor / chain profile) respectively from the end of the headrail, and with a distance of max. 600 mm.

No countersunk screws may be used for fixing.  
Recommendation: DIN 7981 Ø3.8 x 16 mm  
(for wooden and synthetic frames)

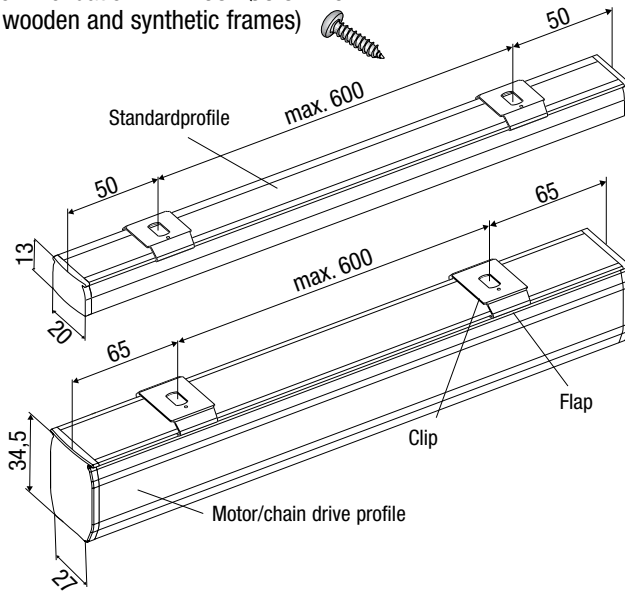

**Mounting:** Place the profile in the back edge of the clip and push the front of the profile upwards (till it clicks in).

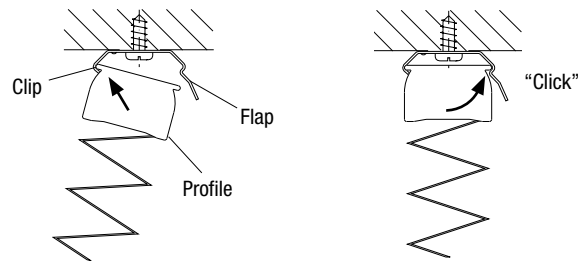

When **dismounting**, push the flap of the clip upwards to be able to take the profile out of the clip.

**Mounting positions:** In the case of a ceiling/wall mounting, make sure that the height of the fabric pack does not collide the tilted or opened wing of the window.

## Mounting possibilities

### Ceiling mounting

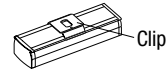

### Wall mounting

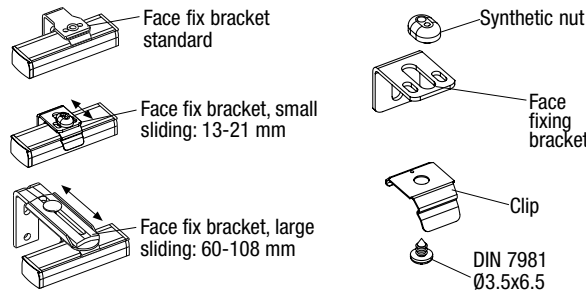

### Mounting on the window with block holder

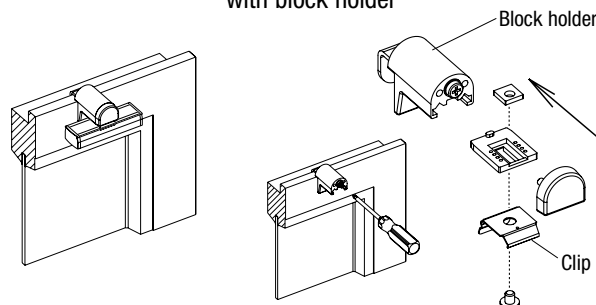

### Tension cord fixing element

Lower the pleated blind and mark the position of the tension cord fixing element. The retaining plate bracket is screwed directly on the block holder or on the face fix bracket. Push the cover over the retaining bracket. The tensioning shim serves to correct the cord tension.

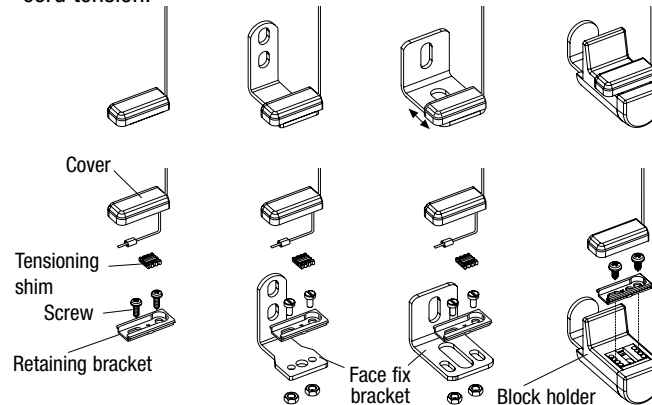

## Mounting possibilities

### Tensioned special models

For all special models with a fixed bottom profile:

1. Mount the bottom clips and click the bottom profile in place.
2. Mount the top clips and click the top profile in place.
3. Mount the clips for side profile and click the side profile in place.

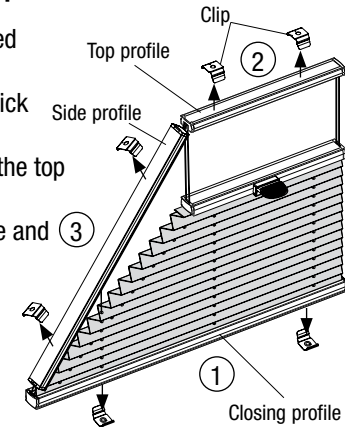

For model 133

1. Mount the top clips and click the top profile in place.
2. Fix the retaining brackets as already described.

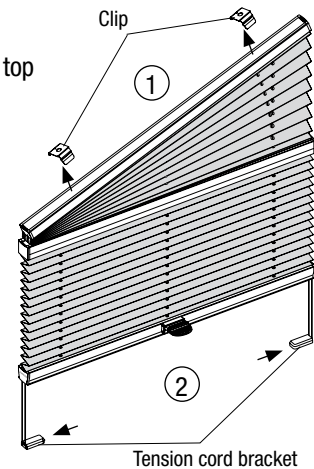

### Stationary models

Fit the clips and click in the profiles.  
Fit additional hooks behind the position of the fabric rivets and insert the fabric.

